

**Home**Scroll down  
or click **Home**  
to return back**Melbourne House. The Street.****Click here  
for P.D.F.**

Search

 THE WEB  FRESHFORD SITE

It has been difficult in the past to puzzle out the earliest history of this house as it is obviously Georgian and had been refronted with two bow windows judging from early photographs that show it with 3 upper floor windows instead of the present two. The Census and Tithe Map reveal that Ann Liddon, daughter of James Warden owned it and lived there with her two unmarried daughters. I always assumed that as she owned most of the village as Lady of the Manor it had been originally owned by her father and that was as far as I could go back. Since studying the Land Tax and Poor Rate records I have at last been able to take it back to when it was built in 1811 on land given by Benedicta Durston to her Steward - Thomas Rickard, by his daughter, Mary. The missing link was a crossed out entry in the Land Tax List for 1831 which details Mrs Liddon as the new owner of the "Stone House" in that year. In the past I had assumed that this referred to the present Stone House on the Street, but checking the records for that year it seems to have been occupied by Dr. Sweeting. Fortunately the name of the house appears in the tax records back as far as 1811, which must have been the year it was built as there is no details before then. Mary Rickard is the owner in that year and seems to have built it in a field that she already had inherited from her father. It is described as The Stone House and she rents it out to a Mrs. Ridout, who is paying 5/- Land Tax on it, whilst she continues to live in a smaller property paying 1/9d. The 1841 Tithe Map shows it must have had a larger plot of land called Guppy's behind it as it was later bisected by the Old Lyme Road. The 1825 Poor Rates detail that Benjamin Love was renting the adjacent field from Misses Rickards which is described as New Road Close. The records shown here will help to substantiate that the house was built in 1811 on a field once owned by the Lord of the Manor by Mary Rickard and was later bought in 1832 by Ann Liddon, whose family continued to own it until 1886.



*Benedicta Durston* Lady of the Manor of Charmouth in the County of Dorset did in and by her Deputation (under her Hand and Seal) bearing Date the fourth Day of October in the Year of our said One Thousand Seven Hundred and Seventy nominate constitute and appoint Thomas Rickard (her Bailiff and Agent) to be her gamekeeper of and within her said Manors of Charmouth Catherstone and Newlands with full power License and Authority to kill Game in and upon the said Manors of Charmouth Catherstone and Newlands for her sole use and immediate Benefit, and also to take and seize all such Guns and other Engines for the taking and killing of Game within the Precincts of the said Manors of Charmouth Catherstone and Newlands that shall be used by any Person or persons who by Law are prohibited to keep or use the same.

The Quarter Sessions book in 1770 clearly describes his role for Benedicta as follows:  
 "Benedicta Durston, Lady of the Manor of Charmouth in the County of Dorset did and by her deputation in the year 1770 nominate constitute and appoint Thomas Rickard (her Bailiff and Agent) to be her gamekeeper of within the said Manors of Charmouth, Catherston and Newlands with full power and License and authority to kill game in the said Manors for her sole use".

1786 Will "I Thomas Rickard of Charmouth bequeath to my wife Sarah all those estates, messuages lands and tenements which was given her by her late fathers will 1748 together with my new built stable and garden adjoining and the interest I have in our house and garden and four fields of land which I now hold by three several leases under the hand and seal of Mrs. Durston the lady of the manor of Charmouth to be at her own free will and disposal."  
 In 1753 he married Sarah Bragge in the independent church

1790 No 70  
 John Richards of (sic) Parish of Rumsey and Sarah Rickard of (sic) were  
 Married in this Church by Licence this twelfth Day of February in the Year One Thousand Seven Hundred and Ninety by me Brian Combe Curate.  
 This Marriage was solemnized between Us John Richards Sarah Rickard  
 In the Presence of Elizabeth Rickard M. Baggot

Sarah Rickard remarries in 1790 the brother of her late husband. In 1792 John is born to John and Sarah Rickard. She dies in 1797

Ann Liddon	Stadob &c	son Laidu	3	0	9 1/2
D <sup>o</sup>	D <sup>o</sup>	D <sup>o</sup>	1	1	10
D <sup>o</sup>	D <sup>o</sup>	Farru	1	1	-
D <sup>o</sup>	D <sup>o</sup>	Langmore	-	12	9 1/2
D <sup>o</sup>	D <sup>o</sup>	Hamothu	-	11	4 1/2
D <sup>o</sup>	D <sup>o</sup>	Thos. Platt	-	3	2 1/2
D <sup>o</sup>	D <sup>o</sup>	Turnover	-	3	8
D <sup>o</sup>	S. H. Hill	son Laidu	-	9	2

1810 Land Tax for Ann Liddon

Ann Liddon	Stadob &c	son Laidu	3	0	9 1/2
D <sup>o</sup>	D <sup>o</sup>	D <sup>o</sup>	-	1	10
D <sup>o</sup>	D <sup>o</sup>	Thos. Platt	-	3	2
D <sup>o</sup>	D <sup>o</sup>	Turnover	-	3	8
D <sup>o</sup>	Self	Langmore	-	12	9
D <sup>o</sup>	D <sup>o</sup>	Farru	1	1	-
D <sup>o</sup>	S. H. Hill	Hamothu	-	11	4 1/2
D <sup>o</sup>	S. H. Hill	son Laidu	-	9	2

1810 and 1811 Land Tax for Ann Liddon which shows that Miss Rickard did not buy land from her to build the new Stone House and must have built on a field she already owned.

M. Rickard	Excise Officer for his Salary	8	0	10
"	for his house	0	1	5

1781 Mr Thomas Rickard Excise Officer for his salary £8-0-0 for his house £0-1-5. He died in 1785 and, his wife Sarah is paying 1-7d Land Tax.

Richard Mifs	themselves House	3	"	3	"
Do	M <sup>rs</sup> Bolton	5	"	5	"
Do	Silver Lark Shop & Gard	3/4	"	9	"
Do	James Powell Field	1	"	1	"
Do	W <sup>m</sup> Stephen	1/4	"	1	3
Do	W <sup>m</sup> Bernard House & plot	4	"	14	"

1820 Poor Rates

Mary Rickard	D <sup>o</sup>	D <sup>o</sup>	1	9 1/2
D <sup>o</sup>	Dr. Wragg	Hurlscroft	11	11 1/2
D <sup>o</sup>	J. H. Kitt	Hurlscroft	4	6
D <sup>o</sup>	W. Bernard	Thorn	4	6

1807 Land Tax

Richard Mifs	themselves	House	3	"	3
Do	M <sup>rs</sup> Wragg	Coach House & Gard	1 1/2	"	3
Do	Bonaminlove	New road Clev	1	"	2
Do	William Fox	Field in sea lane	1 1/2	"	3
Do	Bernard James	House & fields	6 1/2	"	10
Do	themselves	House & Gard	9 1/2	"	19

1825 Poor Rates

M. Rickard	Self	House	1	9 1/2
D <sup>o</sup>	linghoff	Minsons Common	3	8
D <sup>o</sup>	J. H. Kitt	Hurlscroft	11	4 1/2
D <sup>o</sup>	W. Bernard	Thorn	4	6

1810 Land Tax

Richard Mifs	Do	Do	6	9
Do	Do	lock & shill	1/4	2 3
Do	Do	Ho L Gard	9/4	14 5
Do	B. Lane	Plot	1	1 6
Do	W. Fox	Do	1/4	2 3
Do	W. Bernard	2 Ho & Gard	6 1/2	10 1/4

1829 Poor Rates

Mary Rickard	Self	House	1	9 1/2
D <sup>o</sup>	linghoff	Minsons Common	3	8
D <sup>o</sup>	J. H. Kitt	Hurlscroft	11	4 1/2
D <sup>o</sup>	W. Bernard	Thorn	4	6
D <sup>o</sup>	Ann Liddon	Stone House	5	0 1/2

1811 Land Tax details Mary Rickard paying Tax for a house where she lives, Minsons Common is a field rented to Mr Russell, John Kitt is renting Hurlscroft, William Bernard is renting Thornes. It is the last record that is of interest as it specifically describes the property as The Stone House for which she is renting to Mr. Liddon who is paying 5 shillings tax on it.

By following the Tax list through subsequent years until 1831 it would seem that The Stone House was sold to Mrs Ann Liddon in that year, as is shown in the record below.

Richard Mifs	themselves	House	3	0
Do	Do	Common	-	9
Do	The Smith	Hurlscroft	11	4 1/2
Do	W. Bernard	Thornes	4	6
M <sup>rs</sup> Ann Liddon	M <sup>rs</sup> Liddon	Stone house	5	0 1/2



# Melbourne House

Liddon Ann H. Moor	Sea Sands	3	0
do	Thomas Plot	3	2
do	Sea Sands	4	2
do	Sat Cousins Common	1	11
do	Jas Cozens Burrows	3	8
do	Herbert Langmore	12	4
do	Land Factory	1	1
do	Mrs Moore House	3	8
do	Hammer	11	1

1827 Land Tax Mrs Ann Liddon - Langmoor

do	do	House	1	9
do	do	Common	1	9
do	do	Whitcroft	1	9
do	do	Thomas	1	9
do	do	Ann Lane	1	9

1831 Land Tax Mrs Ann Liddon buys Stone House from Miss Rickard

Liddon Ann	James Powell	Sea Sands	3	0
do	do	Thomas Plot	3	2
do	do	Sea Sands	4	2
do	Robt Hill	Common	1	10
do	Jas Cozens	Burrows	5	0
do	do	Hammer	11	4
do	Mrs Austen	Langmore	12	4
do	do	Sea Sands	1	1
do	do	House of Sand	1	1

Liddon Ann	Self	House	5	5
Stephens Com	Chas Cator	do	4	4
Liddon Capt	Mrs Hill	do	3	3
Liddon Capt	Mrs Collet	Summons	5	3

1832 Land Tax Mrs Ann Liddon Self, 5s

Mr Liddon	Self	Stone Ho	9	1
-----------	------	----------	---	---

Mrs Liddon	Mrs Cooper	Mrs Gardner	11	1
Mrs Liddon	Mrs Austen	Langmore	12	4
do	do	Sands	1	6
do	Jas Powell	Sea Sands	1	10
do	Jas Cozens	3 Closes	5	7
do	James Cozens	2 do	2	3
do	Mrs Palmer	Mrs Gardner	5	3

1832 Poor Rates Mrs Ann Liddon, Self - Stone House-9 1/2 £ 0-14-3

Ann Liddon	70	Female	2
Sophia Liddon	35	do	2
Lucy do	30	do	2
of Mrs Wilkins	21	P. J. T.	2

1841 Census showing Ann Liddon, aged 70, Daughter of James Warden living with her daughters Sophia, aged 35, and Lucy, aged 30 at Melbourne House. Her eldest son Matthew is a Captain in the Royal Navy.

do	Sophia Liddon	35	Female	2
do	Lucy do	30	do	2

1851 Census showing Sophia and Lucy Liddon living at Melbourne House. Sophia Jackson Liddon died in 1853 and was buried at Chideock.

Lucy Liddon	51	Female	2
-------------	----	--------	---

1861 Census showing Lucy Liddon living at Melbourne House.

Lucy Liddon	72	Female	2
-------------	----	--------	---

1871 Census showing Lucy Liddon living at Melbourne House, aged 72.

21 March. Administration of the Personal Estate of Lucy Liddon late of Charmouth in the County of Dorset Spinster who died 22 January 1879 at Charmouth was granted at the Principal Registry to Dame Eliza Lucy Grey (Wife of Sir George Grey, Knight) of Gonville Madeira Vale Ventnor Isle of Wight in the County of Southampton the Niece and one of the Next of Kin.

Melbourne House stands on part of a field which had in previous centuries been known as Guppy's tenement. there was no doubt an earlier building which had belonged to members of the Guppy family who regularly appeared in the Parish records. There are a number of references to Guppy's Tenement in old documents. The adjoining property now known as "The Well Head", used to be the Farm House for Foxley Farm and was bought by John Minson of Eype in 1711 has deeds that are relevant. For in 1735 Anthony Ellesden, the Lord of the Manor, granted to John Minson...**all that cottage in Charmouth called Guppy's tenement, consisting of a Messuage, garden and meadow called Common Close containing 1 acre and common Pasture in a Common called Langmore with the appurtenances were formerly in the possession of George Mantle.** It would seem from this that the property was owned by the Lords of the Manor, which could be traced back to the Abbots of Forde, who were owners of the village from 1139 until 1539. The Cartulary which still exists details what is probably a reference to the land when it describes the boundaries of the new Borough of Charmouth in 1320 as follows: **" every burgess residing in the borough might with his horse or bullocks into Common Land vis. From the road where Geoffrey Heyrun lives westward. So to Stephen Payn's and to the ditch which was Robert Rossi's to the Langoresgeth ( langmore Gate ) and then to the Steps"**.

Though there are early references to the Guppy family in the parish records from 1666 when Spese Guppy married Card. The property got its name from William Guppy who met an unfortunate end with others in the village as a supporter of the abortive attempt by the Duke of Monmouth to seize the throne in 1685. He was amongst 16 villagers suspected as rebels. He was tried at Dorchester by the notorious judge Jeffries and transported from Weymouth on the way to Barbados, but tragically died on board the Betty on December 17th 1685. The name of his continued to be used as a description of the property and appears amongst the list of the Lords of the Manor lands. The earliest accurate Map for Charmouth is the 1841 Tithe map, which provides some interesting information. It would appear that the title Guppy's Tenement is given to 3 separate plots - nos, 94, 147 and 148. Combined these add up to just over the acre referred to in the 1735 deed. An explanation for this is that Old Lyme Road is a relatively new road being built in 1825 to replace the Old Roman road, which was both steep and dangerous. Hence plot 147 and 148 were once one larger field before being dissected. The Tithe map reference book shows the owner as Anne Liddon who as Lady of the Manor owns considerable property in the village. She is the daughter of Lieutenant James Warden R.N. who purchased the Manor of Charmouth in 1788 from a descendant of Anthony Ellesden. He had a fiery temper and even disowned his own son, who was to receive just £20 a year during his life. In 1789 he won an action against the Rev. Brian Combe and others for removing sand and seaweed from the beach. His arguments climaxed with a disagreement with a neighbour, Norman Bond that resulted in a duel at Hunter's Lodge Inn



with James being shot through the heart and the neighbour fleeing the country to Barbados. In his Will he was to provide just an Annuity to his eldest son, William Warden of £20 a year to be provided out of the income from "Guppy's tenement". Matthew, the grandson of James Warden after the death of his mother places the Manor up for Auction in London in 1853, where it is bought By George Freat of the famous Biscuit family. The particulars of the Auction Catalogue provide an insight into the complicated Annuity:

**No. 10 That as under a will, proved in 1792 (James Warden), this property is charged with an annuity of £20 payable to a gentleman (James Wardens son) now aged 86 years, the vendors shall not be required to procure a release or a discharge of the premises from the annuity, but the same shall bereturn3ed on a House, Garden and Field, called Guppy`s Tenement, containing 1 acre 17 perches, in the occupation of Matthew John Liddon Esq & Joseph Hodges, situate in Charmouth of the annual value of £30 or otherwise, for the purchaser shall accept the joint and several covenants of the Vendors for his indemnity against the said annuity, at the option of the vendors, and it shall not be required of the vendors to obtain any conveyance or reconveyance of any legal estate in reference to such annuity or the concurrence of any trustees or trustee in respect of any trust created more than 40 years before the date therof.**

**CHARMOUTH, DORSET.**

**Desirable Manor and Lands for Sale,—A most Valuable Freehold Property.**

**T**HE MANOR OF CHARMOUTH, with its MANORIAL RIGHTS, and the ESTATES of LANGMOOR and SEA-SIDE LANDS; comprising a very desirable RESIDENCE, called LANGMOOR, (a commodious and well-arranged House, with every requisite for domestic comfort,) situated at the foot of most beautifully wooded Hills and Plantations (by which it is sheltered), and at the same time commanding the most romantic and highly-picturesque Views of the surrounding Country. A variety of Sites for Building, the Scenery from which cannot be surpassed; and containing together about 120 ACRES, a considerable portion of which is exceedingly RICH LAND, will be offered FOR SALE AT AUCTION, in Lots, at the Coach and Horses Inn, in Charmouth, on Wednesday the 27th day of September, 1837, precisely at 12 o'clock, at noon.

Charmouth is well known as a Fashionable Watering Place,—distant about one mile from Lyme Regis, (to which Borough it was attached under the Reform Act,) about five miles from Axminster, and six from Bridport; and the London and Exeter Mails, and other Coaches pass through it daily.

The Neighbourhood abounds with Game.

The Property may be viewed on application to Matthew John Liddon, Esq. Charmouth, who will direct a person to shew it, and of whom printed particulars may be had; as also of Mr. Dawson, Land Surveyor, Exeter; Messrs. Rhodes, Beever, and Lane, 63, Chancery Lane, London; or Messrs. Flood and Mules, Honiton, Devon.

On January 24th 1854 Matthew and Lucy Liddon sell Estate to George Freat of Plymouth for a total of £9100, but after paying off the mortgages they receive £5061. James Warden`s son William is still shown as receiving £20 a year from the Estate.

# THE LIDDON FAMILY 1787-1853



Ann Warden Liddon



Langmoor Manor



James Warden`s Tomb



Matthew Liddon`s Memorial



Sir Richard Spencer

Liddon Family Tree

James Warden  
Lieutenant in 1760  
Buys Manor of Charmouth in 1787  
Died 1792 in a Duel with a neighbour

Elizabeth Newell  
1750-1798

Spencer Family Tree



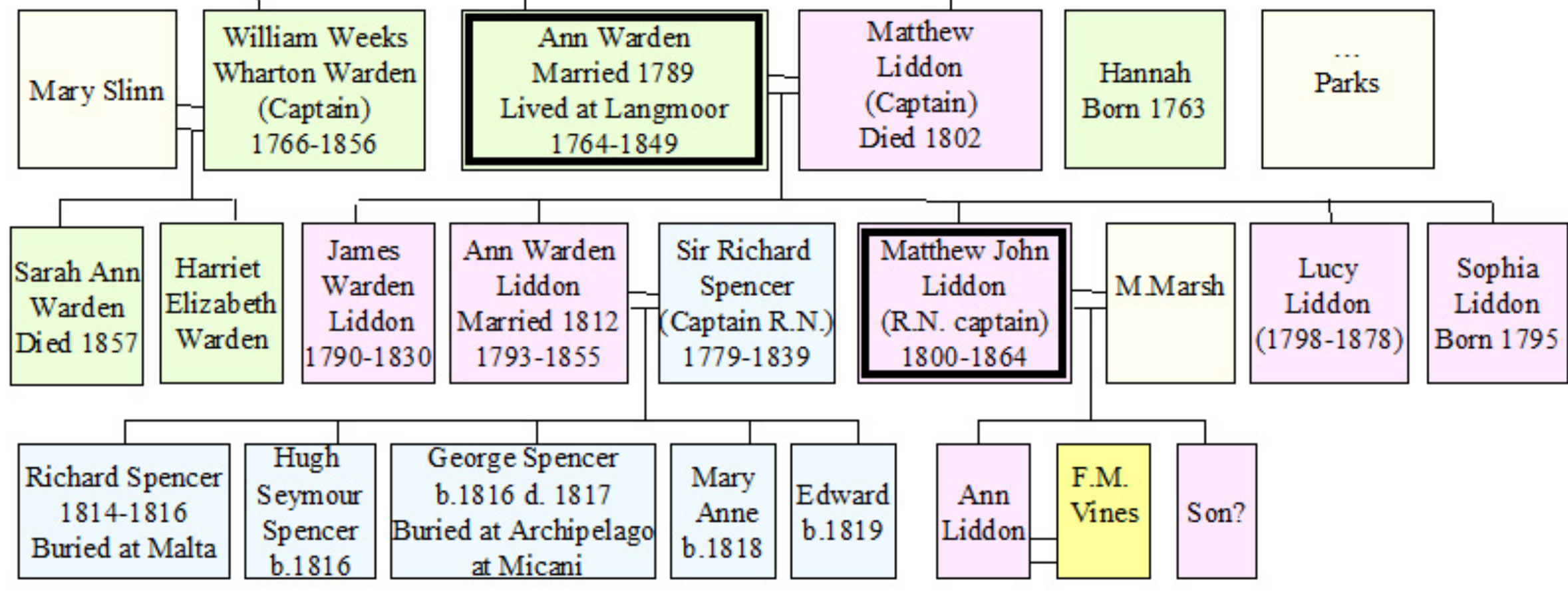

James Wardens Will for 1792 mentions that "I bequeath unto my dear wife my house on the north side of Charmouth Street in part of which farmer Bowditch now resides with the outhouses thereto belonging and one common of pasture called Thomas's plot adjoining the Fountain Meadow and one other plot called Little Grange on the north side of Charmouth Street opposite Roadhorn Hill". It would appear from this abstract that James and his wife were living oin the Old Manor House opposite the Church. He had only bought the Manor of Charmouth 4 years before his untimely death in a duel and it would seem that "Langmoor Manor was not finsihed. Little Grange would be wehdere Askew House would later be built and Thomass`s plot is no doubt. The 1783 Esate boom for the village has Little Grange as occupying 3roods 1 perch and TThomas Orchard 1 rood 29perches and Thomas`s plot as 1 acre 8 perches.

1853 sales catalogue No.10 That as under a will proved in 1792, this property is charged with an annuity of £20 payable to a gentleman ( W.W.W. Warden) now aged 86 years, the vendors shall not be required to procure a release or other discharge of the premises from the annuity, but the same shall be returned on a House, garden and Field, called Guppy`s Tenement containing 1 acre, 17 perches, in the occupation of M.J. Liddon Esq and James Hodges, situate in Charmouth, of the annual rent of £30 or otherwise, for the purchaser shall accept the joint & several covenants of the vendors for his indemnity against the said annuity, at the option of the vendors, and it shall noit be required of the vedors to obtain any conveyance or reconveyance of any trustess or trustee in respect of any trust created more than 40 years the date hereof

70	Ann Liddon	70	Ind	7
35	Sophia Liddon	35	De	2
30	Lucy Liddon	30	De	2
20	Mary Wilkins	20	P. J. +	2

1841 Census showing Ann Liddon, aged 70, Daughter of James Warden living with her daughters Sophia, aged 35, and Lucy, aged 30 at Melbourne House. On the death of her Mother, the property passed to Ann, who had married captain Matthew Liddon, R.N. They appear to have been badly off, as the Estate was mortgaged to raise money for the education of her children, and Langmore Manor was occupied by Mrs. Austin. Prior to this year Ann rented Melbourne House and from 1821 to 1832, the Poor Rates show Mrs Palmer living at Melbourne House.

29	Sophia J Liddon	Head	11	55	Trustholder
	Lucy	Sister	11	52	Trustholder

1851 Census showing Sophia and Lucy Liddon living at Melbourne House. Sophia Jackson Liddon died in 1853 and was buried at Chideock. The present owners of Melbourne House have kindly allowed me to study their deeds, which I have abbreviated, as many are long winded and repetitive. They supply useful infoarmtion and dates regarding the house.

The earliest is dated October 1st 1867 and refers to Lucy Liddon of Charmouth, Dorset, Spinster of the 1st part, Honor Maria Liddon, Widow and Matthew Liddon, her son, (a minor of about the age 6 years) both of Chideock in the said County of the 2nd part and Andrew Tucker of Charmouth, Gentleman and William James Atkins of Lyme Regis , Bank Manager, who were the trustees of the 3rd part. It shows that the said Lucy Liddon and her brother Mathew John Liddon, a Captain in the Royal Navy, deceased, were at the time of his decease jointly entitled to the dwelling house, garden and close of land. He died on the 3rd May 1864, intestate, leaving the said H.M. Liddon, his widow and the said M. Liddon, his only son and heir at law.





THE CHURCH at this place was most tastefully decorated for the feast of the Ascension.

WE REGRET very much to announce the death of Matthew John Liddon, Esq., Capt. R.N., of this place, and also of Walnut Cottage, Andover, at which latter place he expired suddenly on Tuesday, the 3rd instant. The deceased gentleman was very much respected by all who knew him, especially in Charmouth and the neighbourhood, and his loss is most deeply felt both by his relatives and a large circle of friends. His remains were interred on Saturday last, the 7th inst., in a vault in Charmouth churchyard. He was in his 63rd year.

It was agreed that the said Lucy Liddon should retain life interest in the house, and released from payment of rents. It would then pass to her nephew, Matthew Liddon. All that property on the south west side of the Main Street in occupancy of L. Liddon and Mr. Bazley Dean, her tenant.

But events take over and Honor Maria, wife of the late Matthew Liddon remarries William Harris of Penderfield Road, Wakefield in 1867. Her son Matthew died young in 1879, leaving his estate to his sister Anne. When Lucy Liddon, the occupier of Melbourne House died in 1879, it was left empty until 1884, when her niece inherited the house on her attaining the age of 21. Anne Liddon married Frank Martin Vines, a Farmer from Gloucester in 1886 and soon after sold Melbourne House to Richard Oliver, who owned a number of properties in Charmouth, for £425.

A description of the property at the time is as follows:

*One undivided moiety of all that de wheeling house, garden and close of land situated at the upper part of Charmouth in the County of Dorset in the South west side of the Main Street or road there containing by measurement 1 acre 17 perches or thereabouts.* It would seem that the house still occupied a large plot. But a portion of the property, being the field fronting the road to Lyme Regis was sold to Frederick Niblett of Longthorpe, Brondesbury, London on the 19th March 1897.

Reginald Pavey, Charmouths famous historian, who lived next door at The Water Head has this to say about Oliver:

*"When Oliver, a former owner, employed Ernest Gollop in the 1880s to put in bay windows, the whole front collapsed and had to be shored up with timber. The workshop over-looking the Lyme Road had been owned by Douglas Board, a carpenter. Board was born in 1850 and at the age of 83 he said that he remembered, as a boy, peeling potatoes at the Rectory for the at the celebration of the Prince of Wales's Wedding. The House was later sold to Thomas Tarr, who sold it back again to Oliver when he bought Portland House for £250. Mary Alice and Fanny who were twins born to John and Elizabeth Coles in 1847, lived there in 1898"*

On his death in 1901, Richard Oliver bequeathed all his properties to his wife Emily. She was to live on for a further five years and her Will revealed that she wished her Trustees to pay the rents to her brother John Lane as long as he lived and then to her sisters Mary Jane Lane and Mary Lane. Mary Lane was to die in 1908, her brother the following year and her sister, who was living in Charmouth in 1914.

A Deed for 1st November, 1910 between Thomas Greenslade Luxton of Cheriton Fitzapaine, Devon Gentleman and George Owen Heath, Exeter, Surveyor of the one part, who acted for the Landlords and Mary Knott of Charmouth, Widow as Tenant. She was paying £27 yearly for a dwelling house known by the name of Melbourne House. Mary in the 1901 Census was shown as a Lady of Independent means, aged 40 living with her sisters, Anne and Agnes Willis. They lived next to Elizabeth Tarrs stationery shop on the Street facing on to Higher Sea lane.

On the death of John Lane, the last of the heirs to Richard Olivers Estate, Melbourne House as well as Grasmere, Omega and The Retreat were placed in an Auction held at The Coach and Horses on the 18th March, 1914. She takes out a mortgage for £400 and pays just over this amount to secure the house. The deed shows that it was "bounded by property of F. Niblett and on the east by the House and Land belonging to A.D. Pass. All said premises were formerly in the occupation of Thomas Tarr, afterwards of Coles and are now in the occupancy of the Purchasee". She was to live there until 1936 when it was purchased by Henry and Elizabeth Stamp for £500. The plan and description show it "with the strip of Garden in front and the yard and ash house in rear and passage at the side thereof and the boundary walls surrounding the same". But the following year they paid a further £100 for the rear garden from Mary Knott, who had moved to Budleigh Salterton. When Henry Stamp finally died in 1962 he left it to his son, Gilbert Henry Stamp, who is described as a Gardener living at Melbourne House and daughter Amelia. She had been married to Frederick Mclachlan and die in 1990, aged 79. When Gilbert died two years alter it was Peter, son of Amelau Mclachlan who was to inherit the house. The Deeds show that Peter and Gillian Butcher were to purchase Melbourne House in 2000.

As a footnote to the connection with Charmouth and the Liddons, The Book of Remembrance in the Church records Harry Liddon Vines, missing April 1943 and Prudence F. Liddon Tosetti was baptied in Charmouth in 1944.





This photograph dating back to 1870 shows Melbourne House in the distance with three windows on the upper floor. It was altered in the 1880s by the owner Oliver according to the historian, Reginald Pavey, who lived next door at The Well Head.





Melbourne House to the right of the photo, with the Well Head in the centre c.1900



The same view today, remarkably similar after 100 years.





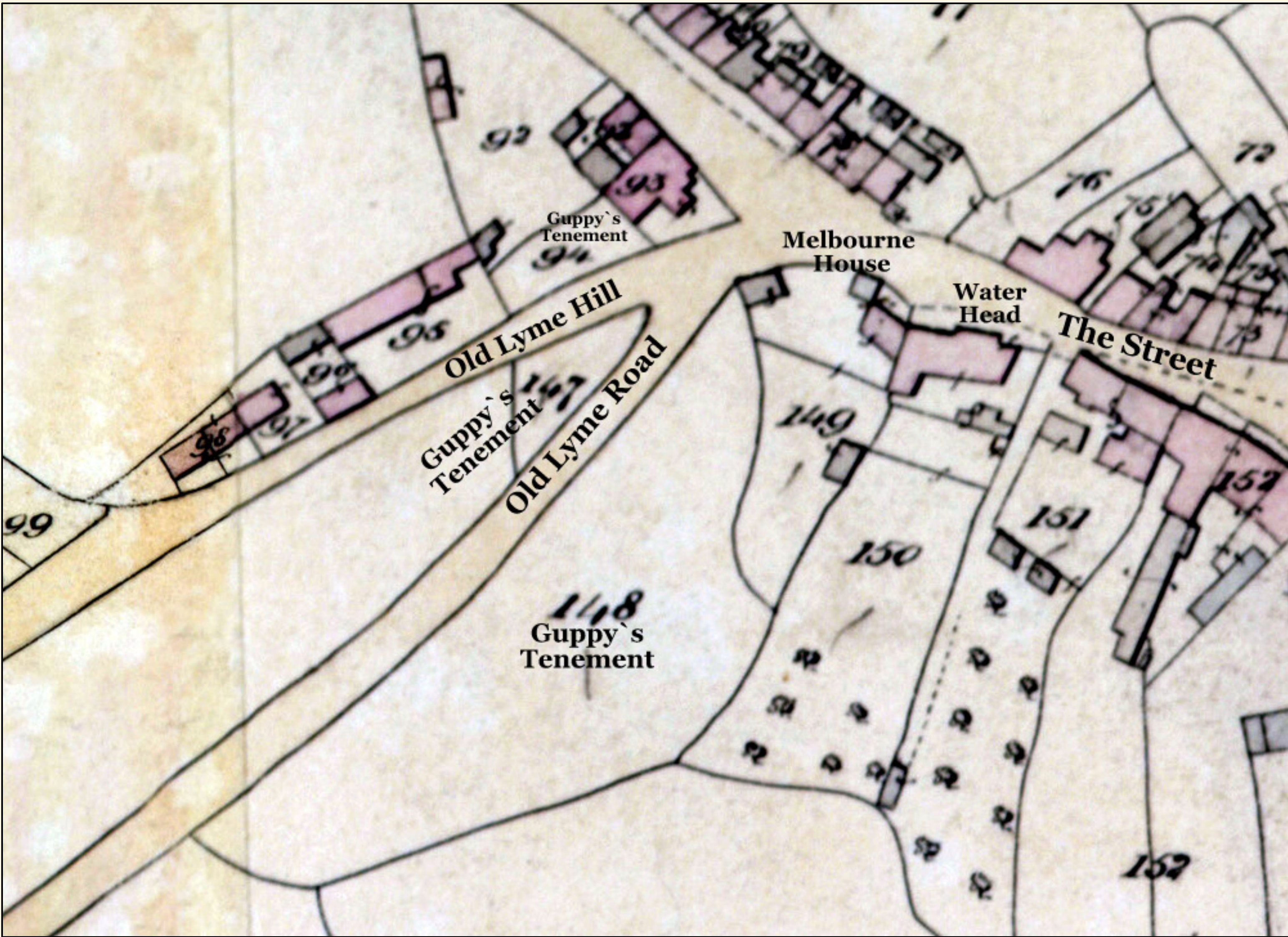



1841 Tithe Map showing Plot 94 Guppy's Tenement - 16 perches, Plot 147 Guppy's Tenement - 8 perches, Plot 148 Guppy's Tenement a Meadow - 3r. 16p, Plot 149 House and Garden (Melbourne House) - 1r 1p.

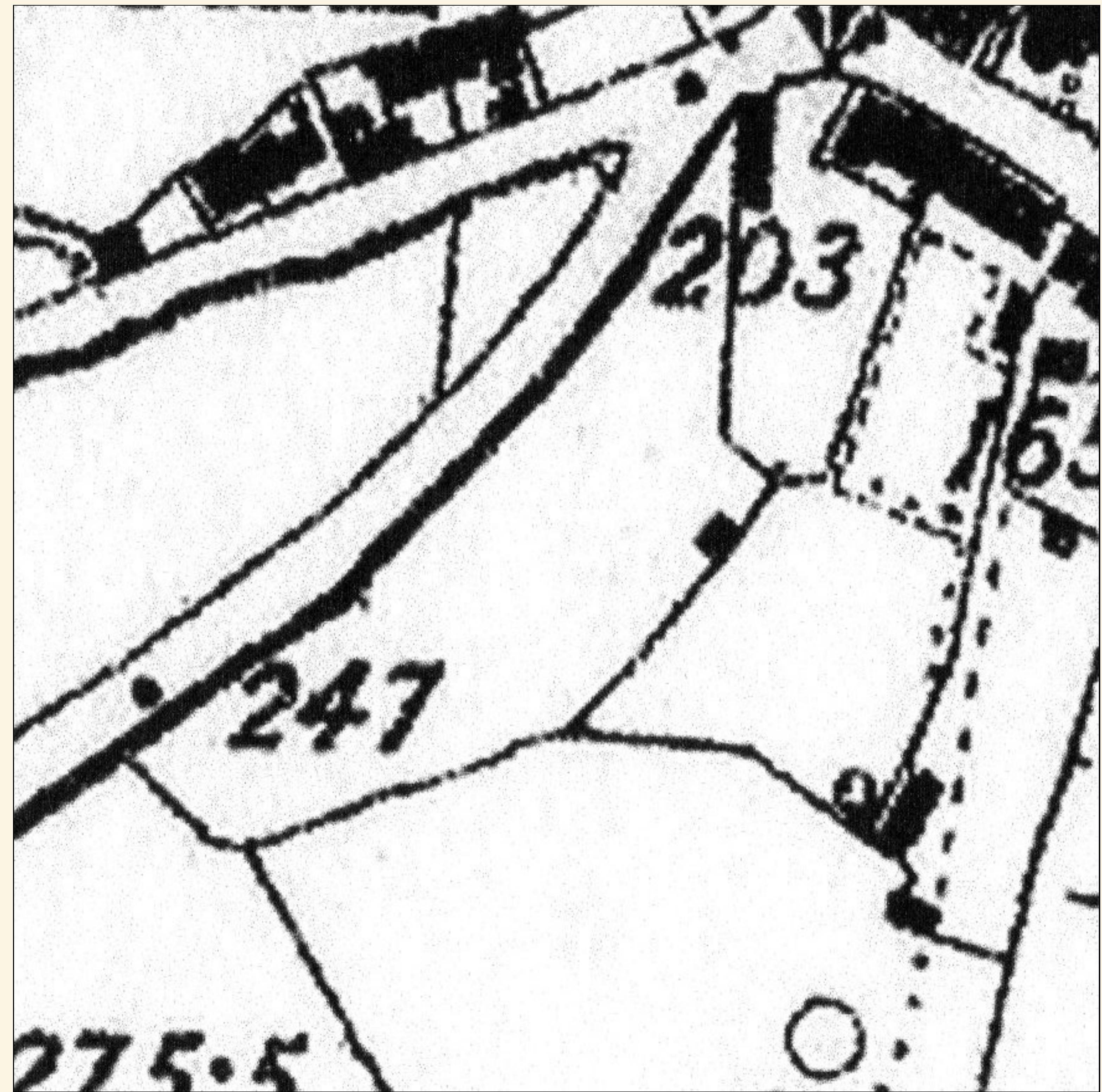

1888 Map showing the property enlarged.

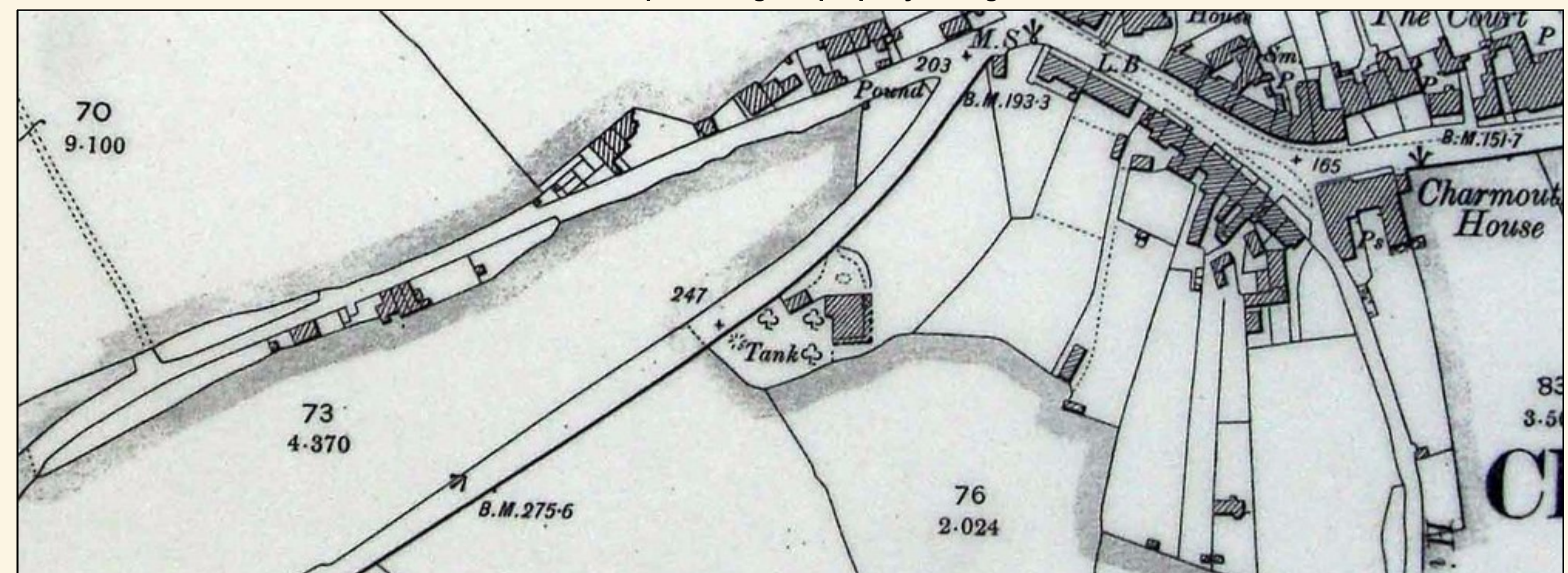



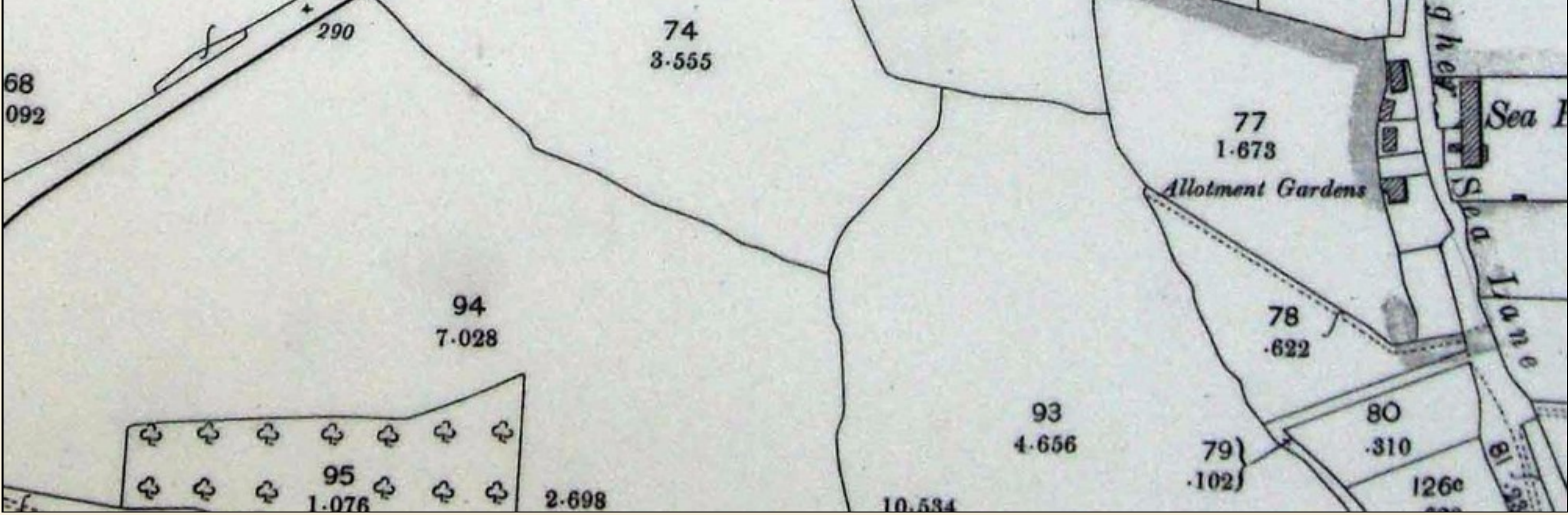

1904 Ordnance Survey map

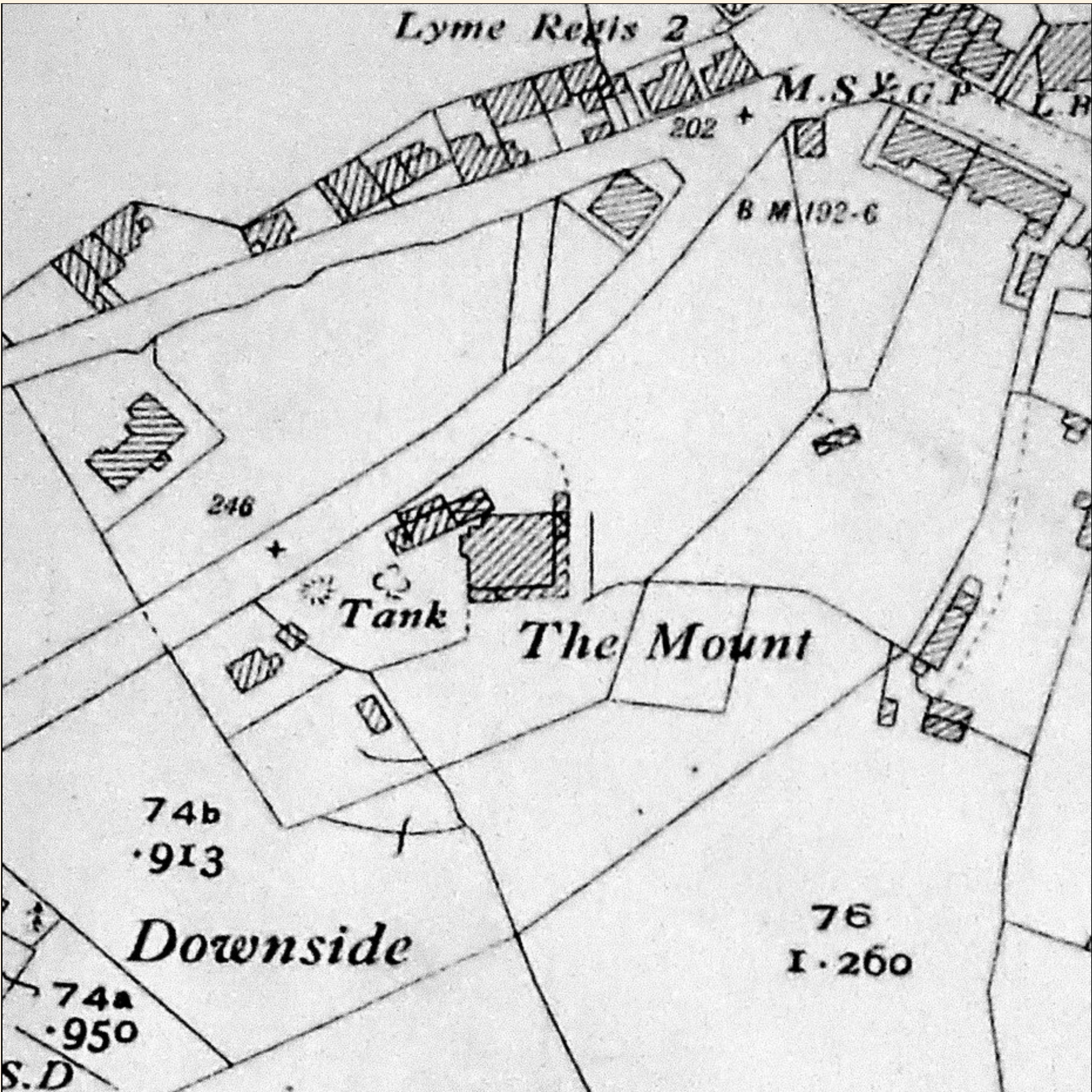

1926 Map showing the house virtually as we see it today.





An aerial view today, showing the additional houses and buildings now occupying what was originally Guppy's Tenement and field.

CHARMOUTH. — FIRE. — On Sunday morning last, a little after midnight, P.C. Cheney discovered the thatch roof of the coach house attached to the dwelling house of Miss Liddon, to be on fire. He made an effort to extinguish it, but was unable, though in doing so he severely burnt his hands. Finding all his efforts were in vain, he awoke the neighbours who got up and came to his assistance. Every effort was made, but of no avail for the coach house was burnt to the ground. We are glad to say that was the extent of the damage, but had it not been for the exertions of the people, P. Sergeant White, and P.C. Cheney, the result may have been very serious, for there are a number of thatched houses in the vicinity, and all would no doubt



have caught fire, if a spacious supply of water had not been thrown on them. Much praise is due to all who assisted. The origin of the fire is unknown, but it is supposed to be the work of an incendiary, who is present but not discovered, though a man charged with the offence was brought up at the Lyme police court, on Tuesday.

LIST OF VISITORS. —

THE COURT : Miss C. Stuart.

HILLSIDE : Rev. C. J. H. Fletcher, Mrs. Fletcher, and family.

SEA VIEW : W. Wyndham, Esq., Mrs. Wyndham, and family.

BOW HOUSE : Major Turner, Mrs. Turner, and family, Miss Mills, the Misses Herring, Mr. Bicknell.

PORTLAND HOUSE : Miss Sealey, Miss Wheeler.

SANDFORD COTTAGE : R. S. C. Sellary, Esq., Mrs. Sellary and Family.

CLARENCE VILLA : D. Sillar, Esq., Mrs. Sillar, and family.

CHARMOUTH HOUSE, No. 1 : Rev. E. Elton, and the Misses Elton.

MR. HOLLY'S, CHARMOUTH HOUSE : Mrs. and Miss Rusk, Mrs. Owen, — Owen, Esq.

PROSPECT PLACE, No. 2 : The Misses Groome.

MRS. T. GORDGE'S : S. Lowe, Esq., Mrs. Lowe, H. Lowe, Esq.

ROSE COTTAGE : Mr. and Mrs. J. Hodges, and family.

MODEL HOUSE : The Misses and Master A. Tippitts.

GRANGE COTTAGE : Rev. E. H. Perkins, Mrs. and Miss Beckley.

MYRTLE COTTAGE : Mrs. E. R. Butler, and family, H. Keatinge, Esq., W. Keatinge, Esq., Master Moore.

N.B.—A visitors' list is kept at Mr. Wellman's, where visitors at any residence will much oblige by giving in their names. The list is sent to this paper every Wednesday. All arrivals after Wednesdays will appear next week.



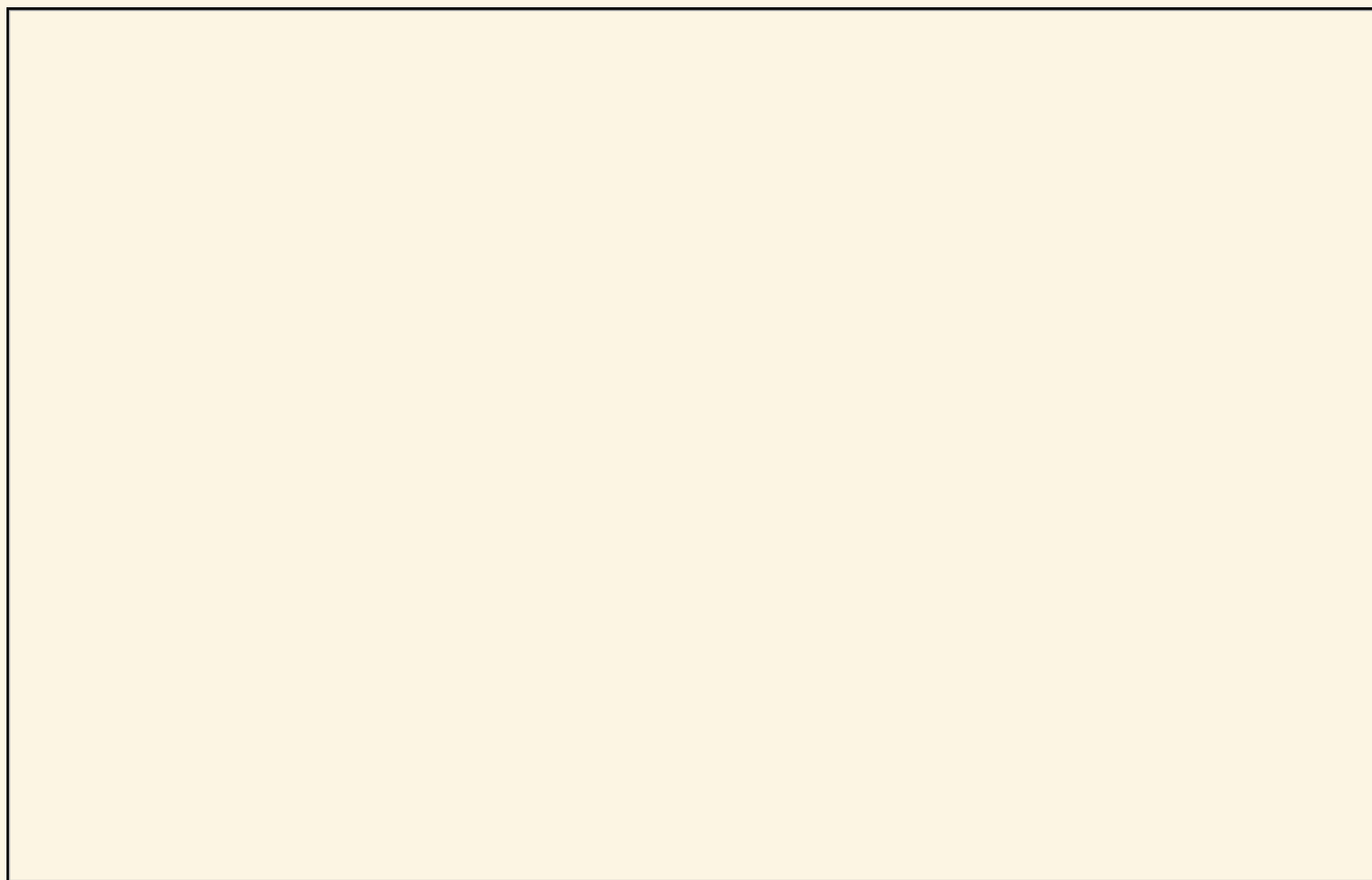

To close a trust estate, Mesrs. Heath Bros., of Bedford Circus, Exeter, conducted a successful sale of freehold residences at the "Coach and Horses" Hotel, Charmouth,, yesterday, "Melbourne House", with a large gardens, let at £27 per annum, was sold to Mr. Linsoll for £402, and "Grasmere" with garden back and front, let at £30 per annum, was secured by Mr. Jackson, solicitor, of Exeter, on behalf of a client for £425. Mr. Jackson also gave £225 for "Omega House", let at £18 per annum; and "The Retreat", with large garden back and front, let at £16 per annum went to Mr. Clarke for £300. Western Times, 20th March 1914. Mr Linsoll, must have been acting as an Agent for Mrs Knott.



The earliest Deed dated 1867, when on the death of her brother, Matthew, Lucy agrees to live rent free in Melbourne House during her life time and leave it to her Nephew on her death.



63.

BIRTHS in the District of *Andover* in the County of *Southampton*

When and where Born.	Name, if any.	Sex.	Name and Surname of Father.	Name and Maiden Surname of Mother.	Rate or Profession of Father.	Signature, Description, and Residence of Informant.	When Registered.	Signature of Registrar.	Baptismal Name, if added after Registration of Birth.
<i>Twenty ninth May 1863 Walnut Cottage Andover</i>	<i>Ann</i>	<i>Girl</i>	<i>Matthew John Liddon</i>	<i>Honor Maria Liddon formerly Marsh</i>	<i>Retired Constable R.N.</i>	<i>Matt. Jno. Liddon Father Walnut Cottage Andover</i>	<i>Fourth June 1863</i>	<i>Edward Reynolds Registrar</i>	

CERTIFIED to be a true Copy of an Entry in the Certified Copy of a Register of Births

The birth certificate for Ann, daughter of Matthew and Honor Liddon, 4th June, 1863.

A portion of the property within described (being the field fronting the road to Lyme Regis) was conveyed by me to Frederic Niblett of Longthorpe Brondesbury London N.W. by Deed dated 19<sup>th</sup> March 1897 and on the same day I signed an acknowledgment and undertaking as to the title Deed in my possession relating to the said property in favour of the said Frederic Niblett.

*Rich<sup>d</sup> Oliver*

The sale of part of the former Guppys lands to Fredderick Nesbitt in 1897 by Richard Oliver.

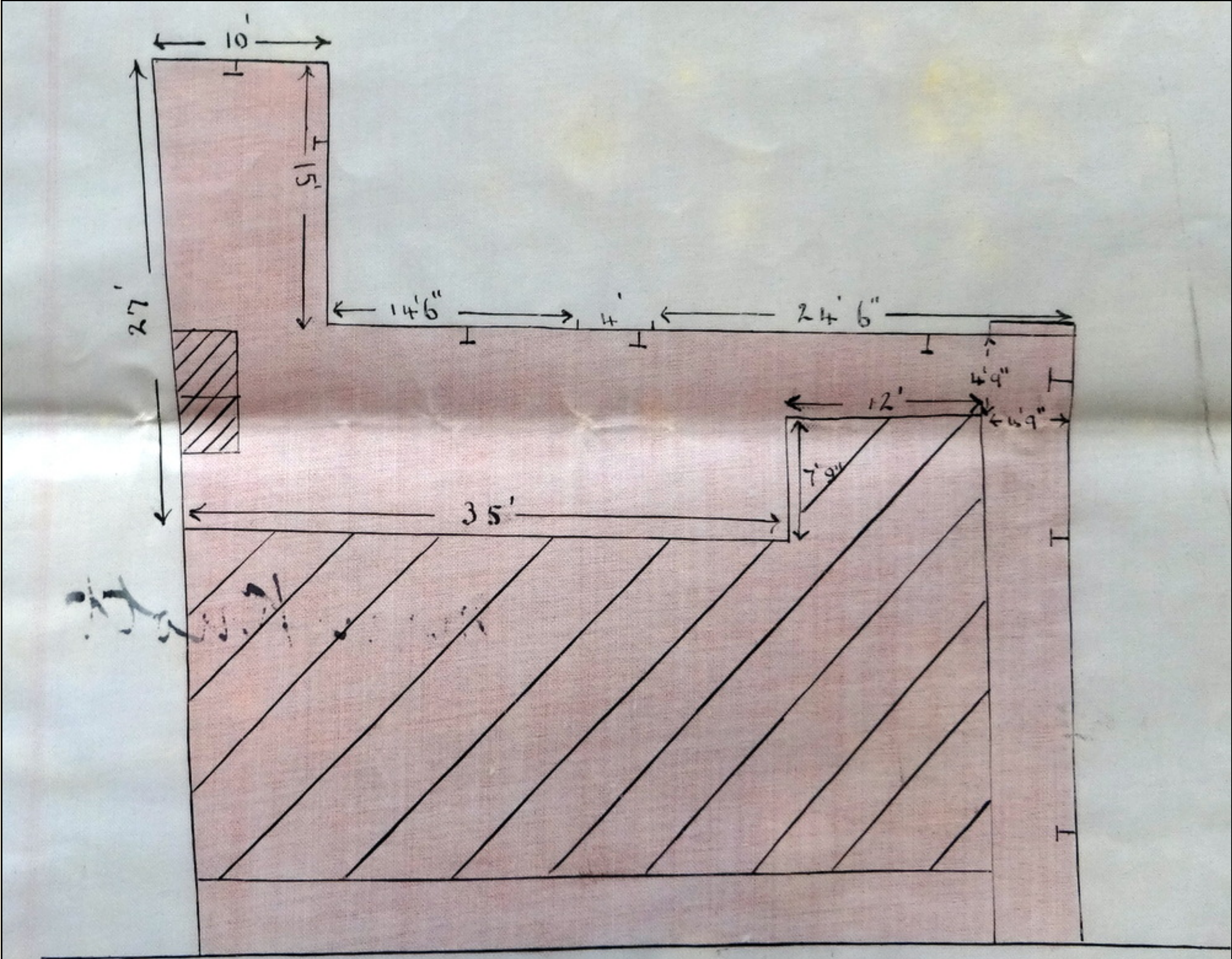

MAIN ROAD



A plan of the property bought by Marsh in 1936.

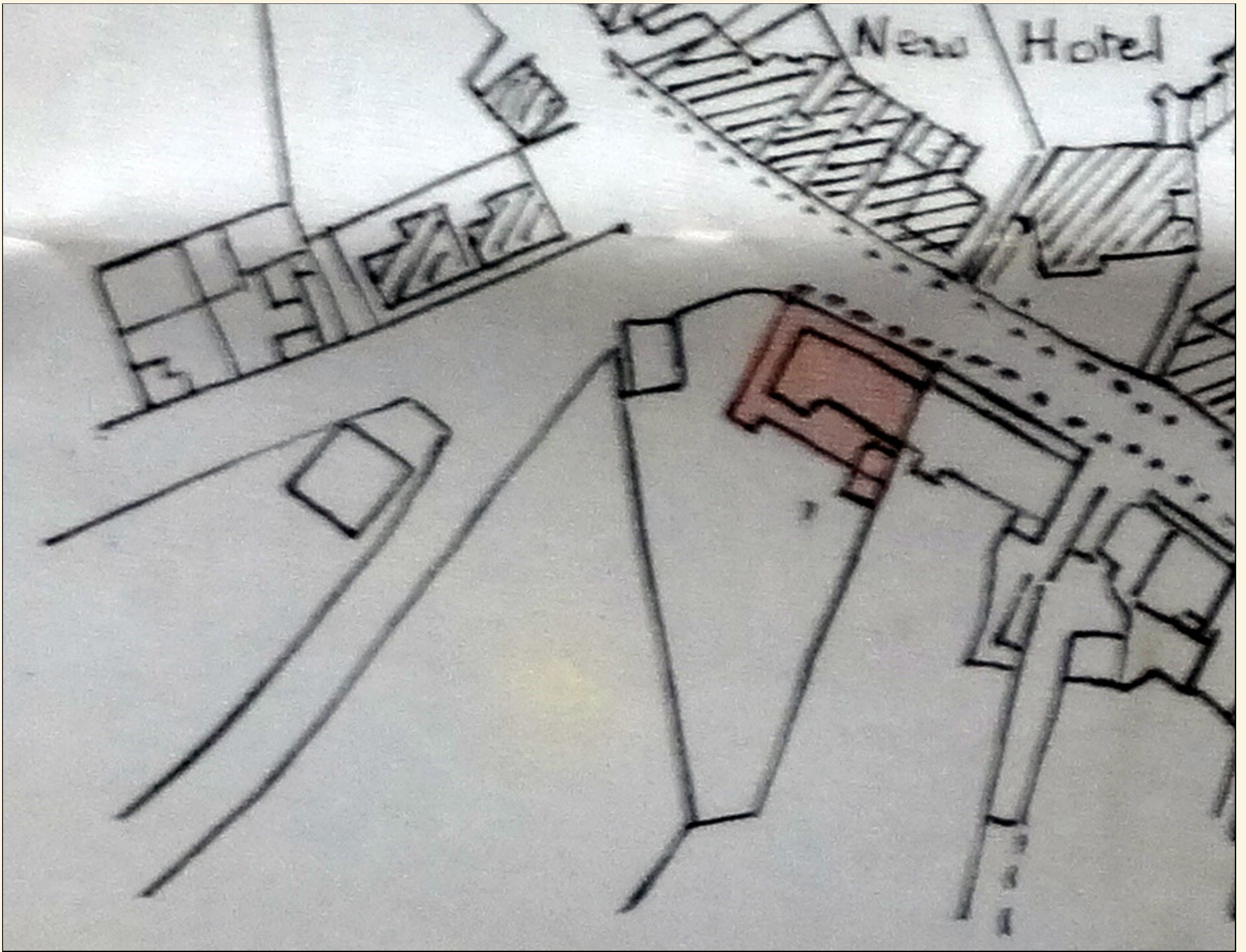

A plan of the property bought by Marsh in 1936.

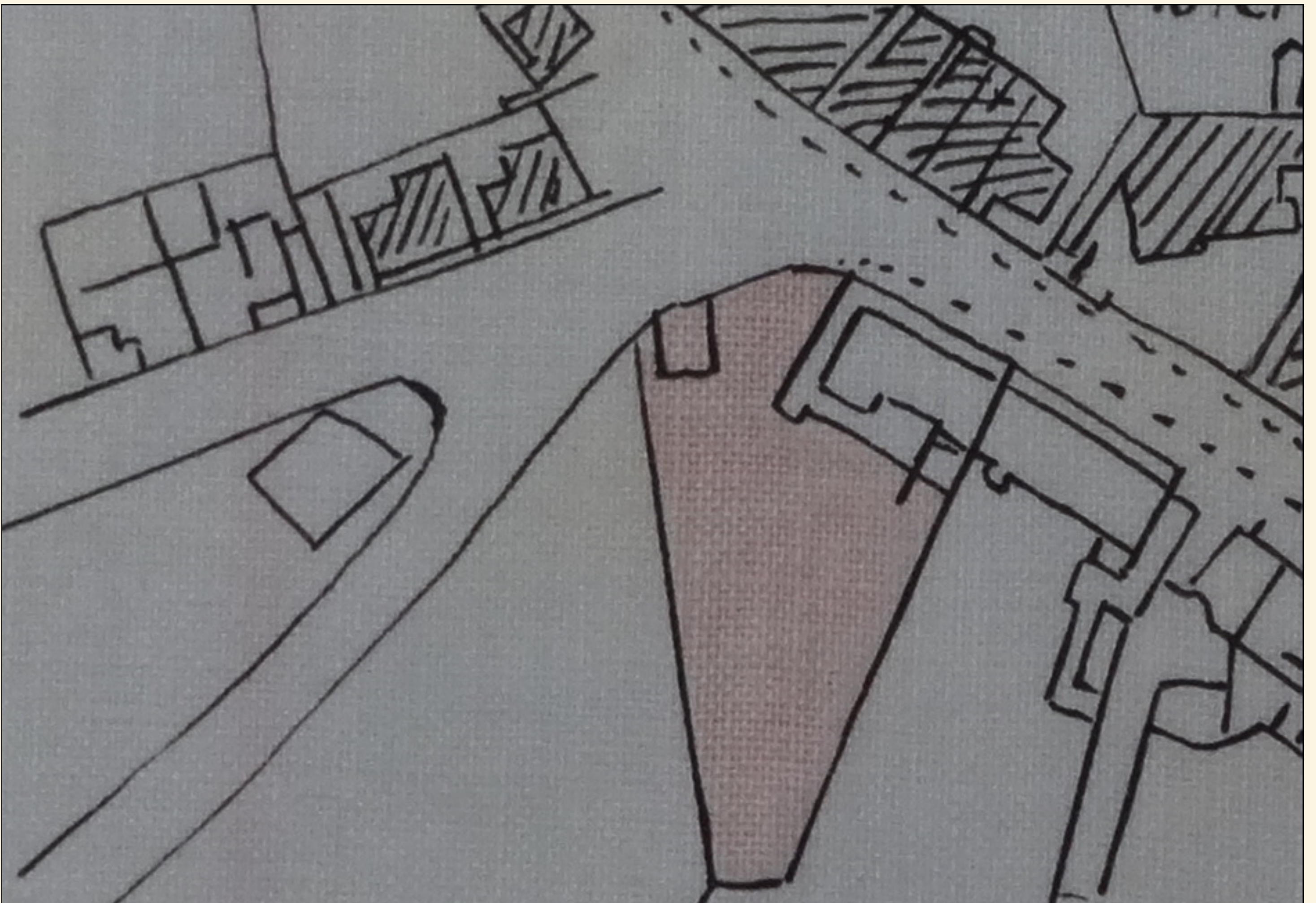



A plan of the property bought by Marsh in 1937, showing the additional land purchased from Mrs Knott for £100

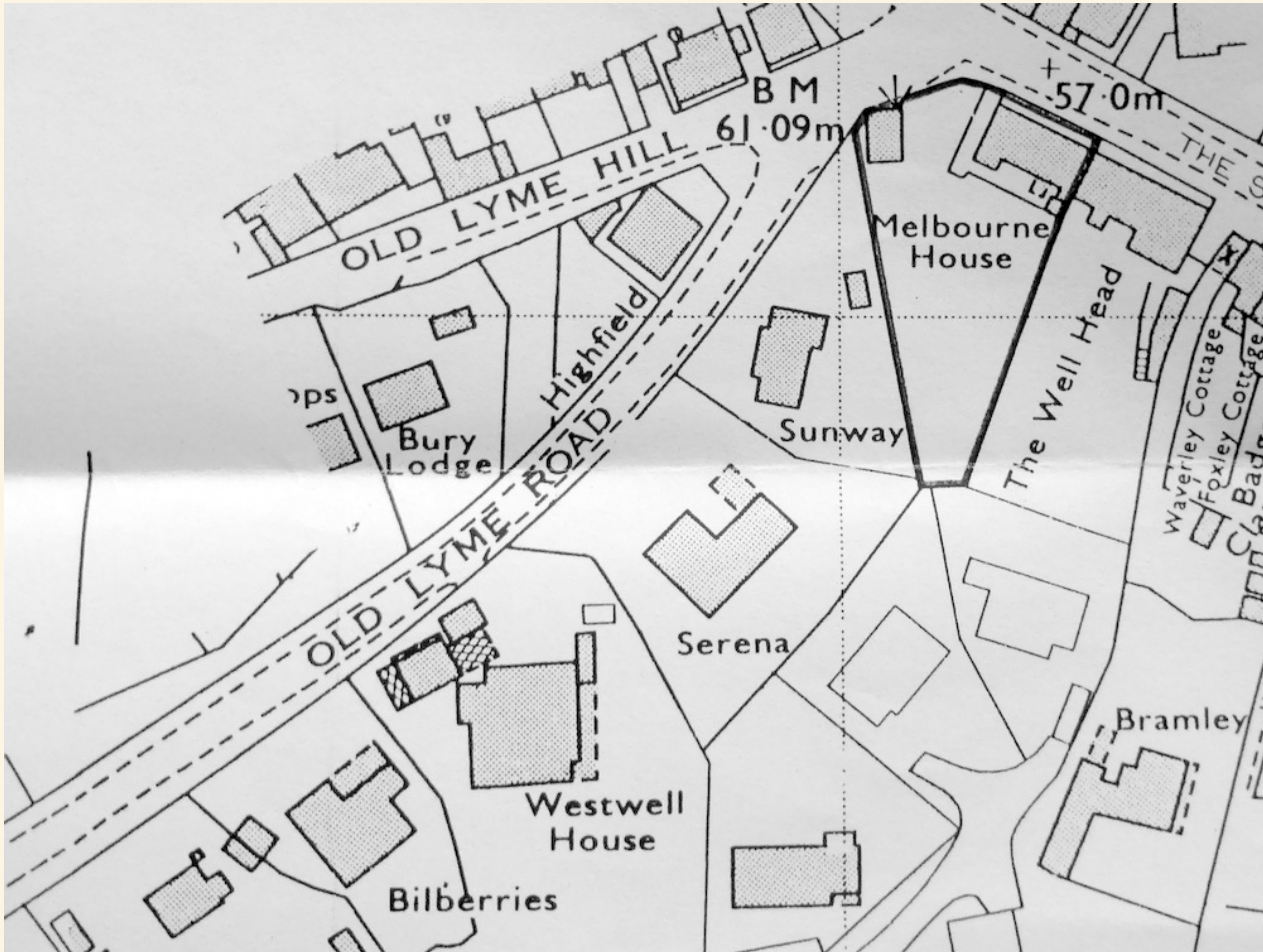

The Land Registry Title today.







081- 647-4916

21-8-94

6 Briar Lane,  
Carshalton,  
Surrey - SM5 4PX

Dear Nick & Georgina

It was very nice to meet you both and see what you are doing to my 'Grandmother' (Mary Knott née Willis's) house and garden. I have had a word with my mother Iris Margareta Norman aged 81 and her sister Dorothea Viviane Gordon aged 85 to see what they can remember about the house and garden. There is not much to say

I think my 'Grandmother' Min must have moved to Melbourne House c1900 when her father became vicar of Wootton Bassett. Her husband Stratton Collings Knott had left her and gone to live at Majeuge in



Madagascar c 1893 where he was vice consul.  
He died there just after the turn of the century.  
Mum died early in the war whilst visiting

a sister at Shotley Bridge Co Durham. She  
is buried at Hindley churchyard in Northumberland.

The picture of Mum and two of her children  
was taken in Newcastle in 1896 and that  
of my mother and her brother Robert c 1914.

My mothers parents are buried just  
inside the cemetery for Earmouth about ten  
feet from the gate. Mums parents are buried  
in church yard at Wootton Fitzpaine by  
a wall which is on your left as you go  
into the church.

Letter relating to Mrs Knott's ownership to Melbourne House, by a descendant.

